

FINAL PROGRAM

THE TENTH ANNUAL  
PA's GUIDE TO THE  
MUSCULOSKELETAL  
GALAXY

PRESENTED BY



JUNE 27–JULY 1, 2018 | NEW ORLEANS, LA

# THE TENTH ANNUAL PA'S GUIDE TO THE MUSCULOSKELETAL GALAXY

## Welcome!

AAPA and the American Academy of Orthopaedic Surgeons (AAOS) are pleased to welcome you to the Tenth Annual PA's Guide to the Musculoskeletal Galaxy in New Orleans, Louisiana. We hope you enjoy this important educational program.

Sincerely,

Christopher V. Bensen, MD  
Travis Randolph, PA-C, ATC  
*Course Directors*

## CME Support

### Financial Support

This activity is supported, in part, by an educational grant from Ferring Pharmaceuticals, Inc.

This activity is supported, in part, by an educational grant from Zimmer Biomet.

### In-Kind Support

Educational supplies for the Acute Care Splinting and Casting Workshop have been provided by an in-kind donation from CNF Medical.



# General Information

---

## ACCREDITATION STATEMENTS

The Galaxy 2018: Acute Care Splinting and Casting Workshop, offered June 27, 2018, has been reviewed and is approved for a maximum of 4.75 AAPA Category 1 CME credits by the AAPA Review Panel. PAs should claim only those hours actually spent participating in the CME activity.

The Galaxy 2018: Injections of Joints and Soft Tissue of the Musculoskeletal System: Upper and Lower Extremities Workshop, offered June 27, 2018, has been reviewed and is approved for a maximum of 3.75 AAPA Category 1 CME credits by the AAPA Review Panel. PAs should claim only those hours actually spent participating in the CME activity.

The Tenth Annual PA's Guide to the Musculoskeletal Galaxy General Course, offered June 28 - July 1, 2018, has been reviewed and is approved for a maximum of 25.25 AAPA Category 1 CME credits by the AAPA Review

Panel. PAs should claim only those hours actually spent participating in the CME activity.

These programs were planned in accordance with AAPA's CME Standards for Live Programs and for Commercial Support of Live Programs.

This educational activity may contain discussion of published and/or investigational uses of agents that are not indicated by the FDA. Therefore, before prescribing any medication, please review the complete prescribing information including indications, contraindications, warnings, precautions, and adverse effects. The information presented is that of the contributing faculty and does not necessarily represent the views of AAPA, AAOS and/or any named commercial entity providing financial support.

---

## ACCESSING ELECTRONIC HANDOUTS

Electronic handouts provided by conference faculty are available under "My Curriculum" in Learning Central.

To access the handouts:

1. Log in to Learning Central at [cme.aapa.org](http://cme.aapa.org) using your AAPA username and password. If you don't know your user credentials, or are unable to log in, please contact [cme@aapa.org](mailto:cme@aapa.org).
2. Click the My Curriculum tab and select the Tenth Annual PA's Guide to the Musculoskeletal Galaxy General Course, Galaxy 2018: Acute Care Splinting and Casting Workshop, or Galaxy 2018: Injections of Joints and Soft Tissue of the Musculoskeletal System: Upper and Lower Extremities Workshop.
3. Click on the yellow Select or Resume button on the top right of the page.
4. Navigate to the Activity Material section and click on the PDFs to open the session handouts.

---

## COMPLETING EVALUATIONS AND OBTAINING A CME CERTIFICATE

Your feedback helps us plan future conferences; therefore, your completion of a course evaluation is a prerequisite for a CME certificate. The course evaluation/CME certificate will be available in AAPA's Learning Central starting on Sunday, July 1, 2018. You will have until Tuesday, July 31, 2018, to complete the evaluation.

Please use the following steps to complete the course evaluation and receive your CME certificate:

1. Log in to Learning Central at [cme.aapa.org](http://cme.aapa.org) using your AAPA username and password. If you don't know your user credentials, or are unable to log in, please contact [cme@aapa.org](mailto:cme@aapa.org).
2. Click the My Curriculum tab and select the Tenth Annual PA's Guide to the Musculoskeletal Galaxy General Course, Galaxy 2018: Acute Care Splinting and Casting Workshop, or Galaxy 2018: Injections of Joints and Soft Tissue of the Musculoskeletal System: Upper and Lower Extremities Workshop.
3. Click on the yellow Select or Resume button on the top right of the page.
4. Navigate to the Evaluation section and click on the Launch button to open and complete the survey.
5. View your certificate under My Transcript.

## PRE-COURSES: WEDNESDAY, JUNE 27

6 a.m. – 6 p.m.	<b>REGISTRATION</b>	Level 2, Grand Ballroom Foyer
7 a.m. – 12 p.m.	<p><b>Acute Care Splinting and Casting Workshop - Morning Session</b>  <i>Thomas V. Gocke, MS, ATC, PA-C, DFAAPA; Daniel Acevedo, PA-C; Mike Harvey, PA-C, MBA; and Travis Randolph, PA-C, ATC</i></p> <p>At the conclusion of this session, participants should be able to:</p> <ul style="list-style-type: none"> <li>• Appropriately apply splint and cast-padding materials for swelling reduction and skin protection</li> <li>• Apply basic acute care splints for common upper and lower extremity injuries</li> <li>• Apply basic casts for common upper and lower extremity injuries</li> </ul>	Level 2, Lafayette Ballroom
8 a.m. – 12 p.m.	<p><b>Injections of Joints and Soft Tissue of the Musculoskeletal System: Upper and Lower Extremities Workshop - Morning Session</b>  <i>Mike Rudzinski, PA-C, RPh; Jason P. Amadeo, PA-C, MPAS; Arden Ballard, MS, PA-C; James Garrett LeBlanc, PA-C; and Bryan P. Seely, PA-C</i></p> <p>At the conclusion of this session, participants should be able to:</p> <ul style="list-style-type: none"> <li>• Discuss indications, contraindications, risks, benefits, materials, and proper technique of injection therapy</li> <li>• Identify common conditions of the upper and lower extremity that may benefit from injection therapy</li> <li>• Demonstrate beginning competencies regarding the location and identification of important functional anatomical landmarks and correct needle placement for injection therapy</li> </ul>	Level 1, Audubon
1 – 5 p.m.	<p><b>Injections of Joints and Soft Tissue of the Musculoskeletal System: Upper and Lower Extremities Workshop - Afternoon Session</b>  <i>Mike Rudzinski, PA-C, RPh; Jason P. Amadeo, PA-C, MPAS; Arden Ballard, MS, PA-C; James Garrett LeBlanc, PA-C; and Bryan P. Seely, PA-C</i></p> <p>At the conclusion of this session, participants should be able to:</p> <ul style="list-style-type: none"> <li>• Discuss indications, contraindications, risks, benefits, materials, and proper technique of injection therapy</li> <li>• Identify common conditions of the upper and lower extremity that may benefit from injection therapy</li> <li>• Demonstrate beginning competencies regarding the location and identification of important functional anatomical landmarks and correct needle placement for injection therapy</li> </ul>	Level 1, Audubon

1 – 6 p.m.	<b>Acute Care Splinting and Casting Workshop - Afternoon Session</b>	Level 2, Lafayette Ballroom
	<i>Thomas V. Gocke, MS, ATC, PA-C, DFAAPA; Daniel Acevedo, PA-C; Mike Harvey, PA-C, MBA; and Travis Randolph, PA-C, ATC</i>	
	<p>At the conclusion of this session, participants should be able to:</p> <ul style="list-style-type: none"> <li>• Appropriately apply splint and cast-padding materials for swelling reduction and skin protection</li> <li>• Apply basic acute care splints for common upper and lower extremity injuries</li> <li>• Apply basic casts for common upper and lower extremity injuries</li> </ul>	
<b>GENERAL COURSE: THURSDAY, JUNE 28</b>		
6:30 a.m. – 5 p.m.	<b>REGISTRATION</b>	Level 2, Grand Ballroom Foyer
7 – 8 a.m.	<b>EXHIBITS AND CONTINENTAL BREAKFAST</b> (Provided)	Level 2, Grand Ballroom Foyer
8 – 8:15 a.m.	<b>Welcome Remarks</b>	Level 2, Grand Ballroom
8:15 – 9:30 a.m.	<b>Basics of Musculoskeletal Imaging</b>	Level 2, Grand Ballroom
	<i>Michael Friedman, MD</i>	
	<p>At the conclusion of this session, participants should be able to:</p> <ul style="list-style-type: none"> <li>• Discuss the basics of radiographic joint evaluation</li> <li>• Describe the imaging options available for evaluating bone and joint pathology</li> <li>• Discuss preferred ordering algorithms of radiologic exams</li> </ul>	
9:30 – 10:30 a.m.	<b>The Language of Fractures</b>	Level 2, Grand Ballroom
	<i>Christopher V. Bensen, MD</i>	
	<p>At the conclusion of this session, participants should be able to:</p> <ul style="list-style-type: none"> <li>• Discuss basic fracture terminology and nomenclature</li> <li>• Recognize common fracture patterns, morphology, and classification</li> <li>• Describe appropriate treatment plans for common fractures</li> </ul>	
10:30 – 10:45 a.m.	<b>EXHIBITS/BREAK</b>	Level 2, Grand Ballroom Foyer
10:45 – 11:45 a.m.	<b>Common Orthopaedic Conditions of the Knee</b>	Level 2, Grand Ballroom
	<i>Wendell M.R. Heard, MD</i>	
	<p>At the conclusion of this session, participants should be able to:</p> <ul style="list-style-type: none"> <li>• Identify essential questions to ask during the medical interview of the injured patient</li> <li>• Perform fundamental physical exam maneuvers to diagnose knee injuries</li> <li>• Identify appropriate imaging studies and interpret them to aid in the diagnosis of knee injuries</li> </ul>	
11:45 a.m. – 12:45 p.m.	<b>EXHIBITS AND LUNCH</b> (Provided)	Level 2, Grand Ballroom Foyer

12:45 – 2:45 p.m.

## FIRST BREAKOUT SESSION

### **Do You See What I See? Commonly Missed Injuries of the Upper and Lower Extremity**

Level 2, Grand Ballroom

*Michael Friedman, MD and Wendell M.R. Heard, MD*

At the conclusion of this session, participants should be able to:

- Discuss appropriate ordering algorithms for cross-sectional imaging, including MRI, CT, and US
- Using a case-based approach, discuss approaches to radiographic interpretation, including commonly missed injuries of the upper and lower extremity
- Using a case-based approach, identify the presentation, exam, work-up and treatment of commonly missed injuries of the upper and lower extremity

### **Emergency Room Treatment of Common Fractures**

Level 1, Broadmoor

*Mike Harvey, PA-C, MBA*

At the conclusion of this session, participants should be able to:

- Explain the initial evaluation and management of common upper and lower extremity fractures
- Discuss the reduction techniques for upper and lower extremity fractures and dislocations
- Explain appropriate splint utilization for upper and lower extremity injuries

### **Lower Extremity and L-Spine Physical Exam Techniques**

Level 2, Lafayette Ballroom

*Daniel Acevedo, PA-C; James Garrett LeBlanc, PA-C; and Bryan P. Seely, PA-C*

At the conclusion of this session, participants should be able to:

- Complete a physical exam of the lower extremity from hip to foot from an orthopaedic surgery perspective
- Complete a physical exam of the lumbosacral spine as it pertains to acute and chronic back injuries
- Develop a differential diagnosis based on physical exam findings

### **Upper Extremity and C-Spine Physical Exam Techniques**

Level 1, Audubon

*Travis Randolph, PA-C, ATC; Arden Ballard, MS, PA-C; and Thomas V. Gocke, MS, ATC, PA-C, DFAAPA*

At the conclusion of this session, participants should be able to:

- Perform a thorough physical exam for an upper extremity or C-spine injury
- Utilize orthopaedic special tests to help diagnose an upper extremity or C-spine injury
- Recognize any range of motion deficits throughout the upper extremity or C-spine
- Identify history questions that can help you formulate a differential diagnosis

2:45 – 3 p.m.	<b>EXHIBITS/BREAK</b>	Level 2, Grand Ballroom Foyer
3 – 5 p.m.	<b>SECOND BREAKOUT SESSION</b>	
	<b>Do You See What I See? Commonly Missed Injuries of the Upper and Lower Extremity</b>	Level 2, Grand Ballroom
	<b>Emergency Room Treatment of Common Fractures</b>	Level 1, Broadmoor
	<b>Lower Extremity and L-Spine Physical Exam Techniques</b>	Level 2, Lafayette Ballroom
	<b>Upper Extremity and C-Spine Physical Exam Techniques</b>	Level 1, Audubon
5 – 6 p.m.	<b>EXHIBITS AND WELCOME RECEPTION</b>	Level 2, Grand Ballroom Foyer
<b>GENERAL COURSE: FRIDAY, JUNE 29</b>		
7 a.m. – 5 p.m.	<b>REGISTRATION</b>	Level 2, Grand Ballroom Foyer
7 – 8 a.m.	<b>EXHIBITS AND CONTINENTAL BREAKFAST</b> (Provided)	Level 2, Grand Ballroom Foyer
8 – 9 a.m.	<b>Common Orthopaedic Conditions of the Shoulder</b> <i>Christopher V. Bensen, MD</i>  At the conclusion of this session, participants should be able to: <ul style="list-style-type: none"> <li>• Recognize common acute and chronic injuries and degenerative conditions of the shoulder</li> <li>• Formulate differential diagnosis for patients with shoulder symptoms</li> <li>• Recommend treatment plans for commonly encountered conditions of the shoulder</li> </ul>	Level 2, Grand Ballroom
9 – 10 a.m.	<b>From Benign to Bad: How to Deal with Common Orthopaedic Conditions of the Elbow</b> <i>Josef K. Eichinger, MD</i>  At the conclusion of this session, participants should be able to: <ul style="list-style-type: none"> <li>• Identify and manage elbow dislocations and their sequelae</li> <li>• Identify and treat common sources of elbow pain and injuries in athletes</li> <li>• Accurately diagnose partial and complete distal biceps tendon injuries</li> <li>• Implement injury avoidance strategies for overhead throwers</li> </ul>	Level 2, Grand Ballroom
10 – 10:15 a.m.	<b>EXHIBITS/BREAK</b>	Level 2, Grand Ballroom Foyer



10:15 – 11:15 a.m.	<b>Common Orthopaedic Conditions of the Wrist and Hand</b> <i>Gleb Medvedev, MD</i>	Level 2, Grand Ballroom
<p>At the conclusion of this session, participants should be able to:</p> <ul style="list-style-type: none"> <li>• Assess an injury to the hand or wrist and formulate a diagnosis</li> <li>• Discuss the pathology of common conditions in the hand and wrist</li> <li>• Discuss treatment options for common conditions of the hand and wrist</li> </ul>		
11:15 a.m. – 12:45 p.m.	<b>LUNCH</b> (On Your Own) Please visit the registration desk for a list of nearby restaurants.	
12:45 – 2:45 p.m.	<b>THIRD BREAKOUT SESSION</b>	
	<b>Do You See What I See? Commonly Missed Injuries of the Upper and Lower Extremity</b>	Level 2, Grand Ballroom
	<b>Emergency Room Treatment of Common Fractures</b>	Level 1, Broadmoor
	<b>Lower Extremity and L-Spine Physical Exam Techniques</b>	Level 2, Lafayette Ballroom
	<b>Upper Extremity and C-Spine Physical Exam Techniques</b>	Level 1, Audubon
2:45 – 3 p.m.	<b>BREAK</b> <span style="float: right;">Level 2, Grand Ballroom Foyer</span>	
3 – 5 p.m.	<b>FOURTH BREAKOUT SESSION</b>	
	<b>Do You See What I See? Commonly Missed Injuries of the Upper and Lower Extremity</b>	Level 2, Grand Ballroom
	<b>Emergency Room Treatment of Common Fractures</b>	Level 1, Broadmoor
	<b>Lower Extremity and L-Spine Physical Exam Techniques</b>	Level 2, Lafayette Ballroom
	<b>Upper Extremity and C-Spine Physical Exam Techniques</b>	Level 1, Audubon
6 – 7:30 p.m.	<b>PRODUCT THEATER</b> <b>Procedure and Practice Injection Workshop</b> This is a promotional workshop that is not eligible for CME credit. Separate registration required.	



## GENERAL COURSE: SATURDAY, JUNE 30

7 a.m. – 5 p.m.	<b>REGISTRATION</b>	Level 2, Grand Ballroom Foyer
7 – 8 a.m.	<b>CONTINENTAL BREAKFAST</b> (Provided)	Level 2, Grand Ballroom Foyer
8 – 9 a.m.	<p><b>Hip Pain: A Focused Approach</b></p> <p><i>Rick Schultz, MD</i></p> <p>At the conclusion of this session, participants should be able to:</p> <ul style="list-style-type: none"> <li>• Discuss the strategy for efficient triage of pain around the hip</li> <li>• Discuss the logic of stepwise diagnosis and treatment of intra-articular sources of hip pain</li> <li>• Discuss the logic of stepwise diagnosis and treatment of the back as the source of hip pain</li> <li>• Discuss the logic of stepwise diagnosis and treatment of the greater trochanter area as the source of hip pain</li> <li>• Identify selected options for surgical treatment of intra-articular sources of hip pain</li> </ul>	Level 2, Grand Ballroom
9 – 10 a.m.	<p><b>Common Orthopaedic Conditions of the Foot and Ankle</b></p> <p><i>Ramon Rodriguez, MD</i></p> <p>At the conclusion of this session, participants should be able to:</p> <ul style="list-style-type: none"> <li>• Properly assess common foot and ankle problems</li> <li>• Diagnose common foot and ankle problems</li> <li>• Discuss treatment of common foot and ankle problems</li> </ul>	Level 2, Grand Ballroom
10 – 10:15 a.m.	<b>BREAK</b>	Level 2, Grand Ballroom Foyer
10:15 – 11:15 a.m.	<p><b>Total Hip and Knee Replacement for the PA in Orthopaedics: Busting the Myths</b></p> <p><i>Harry A. Demos, MD</i></p> <p>At the conclusion of this session, participants should be able to:</p> <ul style="list-style-type: none"> <li>• Discuss indications for and contraindications against total joint replacement surgery</li> <li>• Provide education to patients and answer their questions</li> <li>• Discuss bearing surface options and their impact on implant longevity</li> <li>• Discuss steps to minimize risks and improve outcomes after total joint replacement</li> </ul>	Level 2, Grand Ballroom
11:15 a.m. – 12:15 p.m.	<p><b>Orthopaedic (Total Joint) Infections: Prevention, Diagnosis, and Management</b></p> <p><i>Harry A. Demos, MD</i></p> <p>At the conclusion of this session, participants should be able to:</p> <ul style="list-style-type: none"> <li>• Identify risk factors for infection and strategies for risk modification</li> <li>• Discuss the utility of commonly used tests for the diagnosis of infection</li> <li>• Utilize strategies for the eradication of musculoskeletal infections</li> </ul>	Level 2, Grand Ballroom

12:15 – 1:15 p.m.	<b>LUNCH</b> (Provided)	Level 2, Grand Ballroom Foyer
1:15 – 3:15 p.m.	<b>Orthopaedic Reimbursement and Calculating PA/NP Productivity</b> <i>Tricia Marriott, PA-C, MPAS, MJ Health Law, CHC, DFAAPA</i>  At the conclusion of this session, participants should be able to: <ul style="list-style-type: none"> <li>• Dispel common myths and misunderstandings regarding billing and reimbursement through review of Medicare and commercial payer policies</li> <li>• Describe opportunities to maximize utilization of PAs and APRNs in the orthopaedic practice</li> <li>• Calculate the return on investment/contribution margin when services are provided by PAs/APRNs</li> <li>• Calculate the financial contribution to the global surgical package for care provided by PAs/APRNs</li> </ul>	Level 2, Grand Ballroom
3:15 – 3:30 p.m.	<b>BREAK</b>	Level 2, Grand Ballroom Foyer
3:30 – 5 p.m.	<b>Orthopaedic Panel Discussion: Case Studies and Audience Questions</b> <i>Travis Randolph, PA-C, ATC; Christopher V. Bensen, MD; Harry A. Demos, MD; Thomas V. Gocke, MS, ATC, PA-C, DFAAPA; and Mike Harvey, PA-C, MBA</i>  At the conclusion of this session, participants should be able to: <ul style="list-style-type: none"> <li>• Identify appropriate imaging/testing in complex orthopaedic cases</li> <li>• Discuss operative vs. non-operative treatment in complex orthopaedic cases</li> <li>• Discuss initial management of complex orthopaedic cases</li> </ul>	Level 2, Grand Ballroom

GENERAL COURSE: SUNDAY, JULY 1		
7 a.m. – 12 p.m.	<b>REGISTRATION</b>	Level 2, Grand Ballroom Foyer
7 – 8 a.m.	<b>CONTINENTAL BREAKFAST</b> (Provided)	Level 2, Grand Ballroom Foyer
8 – 9 a.m.	<p><b>Common Orthopaedic Conditions of the Spine</b></p> <p><i>Mathew Cyriac, MD, MBA</i></p> <p>At the conclusion of this session, participants should be able to:</p> <ul style="list-style-type: none"> <li>• Evaluate and treat patients with cervical myelopathy and radiculopathy</li> <li>• Evaluate and treat patients with common lumbar conditions</li> <li>• Identify how to differentiate neck vs. shoulder pain</li> <li>• Identify how to differentiate hip vs. low back pain</li> </ul>	Level 2, Grand Ballroom
9 – 10:15 a.m.	<p><b>Staying Out of Trouble in Pediatric Orthopaedics</b></p> <p><i>Steven D. Gibbons, MD</i></p> <p>At the conclusion of this session, participants should be able to:</p> <ul style="list-style-type: none"> <li>• Recognize signs of hip dysplasia</li> <li>• Identify when to refer common gait problems</li> <li>• Discuss the basics of pediatric fracture care</li> </ul>	Level 2, Grand Ballroom
10:15 – 11:30 a.m.	<p><b>Evaluation of the Injured Athlete</b></p> <p><i>Christopher V. Bensen, MD and Travis Randolph, PA-C, ATC</i></p> <p>At the conclusion of this session, participants should be able to:</p> <ul style="list-style-type: none"> <li>• Recognize sports medicine injuries and illnesses that are seen when covering athletic events</li> <li>• Discuss sideline evaluation of closed head injuries and appropriate management</li> <li>• Identify rehabilitation exercises for non-operative orthopaedic injuries</li> <li>• Discuss the purpose of pre-participation screenings in athletics</li> </ul>	Level 2, Grand Ballroom
11:30 – 11:45 a.m.	<b>Closing Remarks</b>	Level 2, Grand Ballroom

# Faculty

---

**Daniel Acevedo, PA-C**

OrthoVirginia  
Lynchburg, VA

*Disclosures:* No relevant commercial relationships to disclose

**Jason P. Amadeo, PA-C, MPAS**

Louisiana State University Health Science Center  
New Orleans, LA

*Disclosures:* No relevant commercial relationships to disclose

**Arden Ballard, MS, PA-C**

Ochsner Health System  
New Orleans, LA

*Disclosures:* No relevant commercial relationships to disclose

**Christopher V. Bensen, MD**

Keys Medical Group, Lower Keys Medical Center  
Key West, FL

*Disclosures:* No relevant commercial relationships to disclose

**Matthew Cyriac, MD, MBA**

Tulane University School of Medicine  
New Orleans, LA

*Disclosures:* No relevant commercial relationships to disclose

**Harry A. Demos, MD**

Medical University of South Carolina  
Charleston, SC

*Disclosures:* No relevant commercial relationships to disclose

**Josef K. Eichinger, MD**

Medical University of South Carolina  
Charleston, SC

*Disclosures:* No relevant commercial relationships to disclose

**Michael Friedman, MD**

Washington University in St. Louis  
St. Louis, MO

*Disclosures:* No relevant commercial relationships to disclose

**Steven D. Gibbons, MD**

Tulane University Department of Orthopedics  
New Orleans, LA

*Disclosures:* No relevant commercial relationships to disclose

**Thomas V. Gocke, MS, ATC, PA-C, DFAAPA**

Orthopaedic Educational Services, Inc.  
Boone, NC

*Disclosures:* President, Founder, Royalties, Stock, and Intellectual Property - Orthopaedic Educational Services, Inc.; Consultant - Ferring Pharmaceuticals

**Mike Harvey, PA-C, MBA**

OrthoIndy  
Indianapolis, IN

*Disclosures:* Board Member – Physician Assistants in Orthopaedic Surgery

**Wendell M.R. Heard, MD**

Tulane University School of Medicine  
New Orleans, LA

*Disclosures:* No relevant commercial relationships to disclose

**James Garrett LeBlanc, PA-C**

Baton Rouge Orthopedic Clinic  
Baton Rouge, LA

*Disclosures:* No relevant commercial relationships to disclose

**Tricia Marriott, PA-C, MPAS, MJ Health Law, CHC, DFAAPA**

Trinity Health Of New England – Saint Mary's Hospital  
Waterbury, CT

*Disclosures:* No relevant commercial relationships to disclose

**Gleb Medvedev, MD**

Tulane University Department of Orthopedics  
New Orleans, LA

*Disclosures:* No relevant commercial relationships to disclose

**Travis Randolph, PA-C, ATC**

West Virginia University  
Morgantown, WV

*Disclosures:* Speaker's Bureau - Ferring Pharmaceuticals

**Ramon Rodriguez, MD**

Tulane University School of Medicine  
New Orleans, LA

*Disclosures:* No relevant commercial relationships to disclose

**Mike Rudzinski, PA-C, RPh**

Buffalo VA Medical Center  
Buffalo, NY

*Disclosures:* No relevant commercial relationships to disclose

**Rick Schultz, MD**

Texas A&M Health Science Center  
Round Rock, TX

*Disclosures:* No relevant commercial relationships to disclose

**Bryan P. Seely, PA-C**

Tulane Medical School  
New Orleans, LA

*Disclosures:* No relevant commercial relationships to disclose

# The Ritz-Carlton, New Orleans Floor Plan

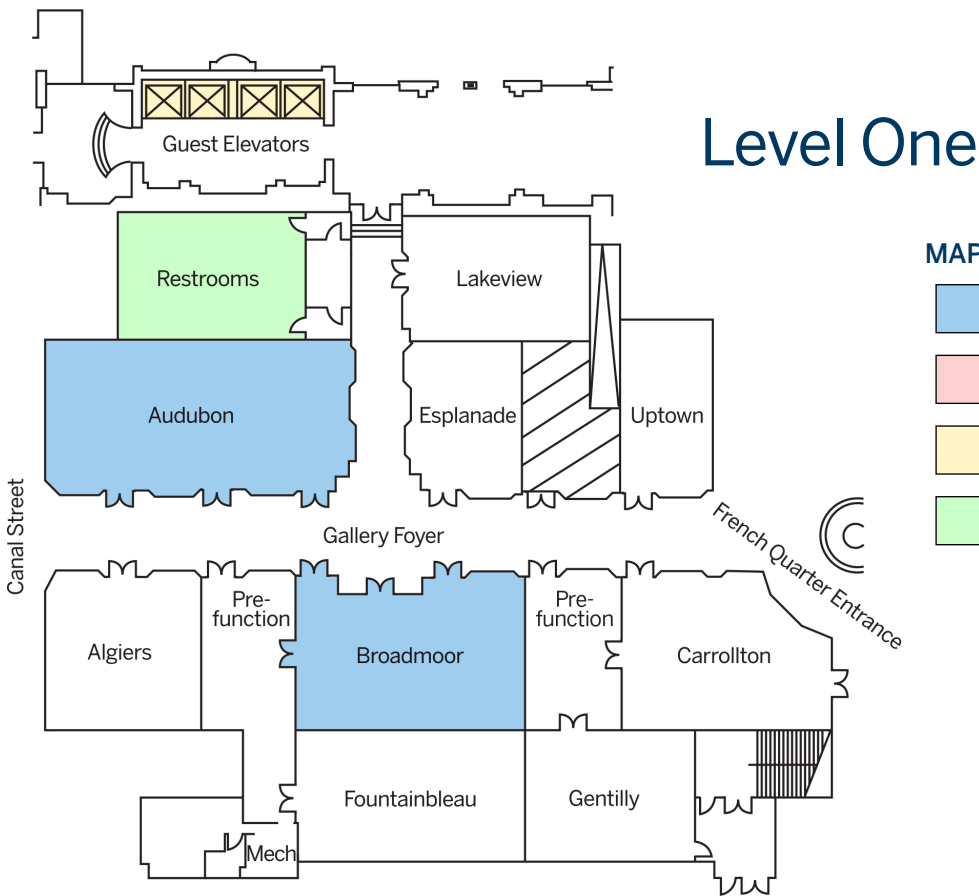

## Level Two

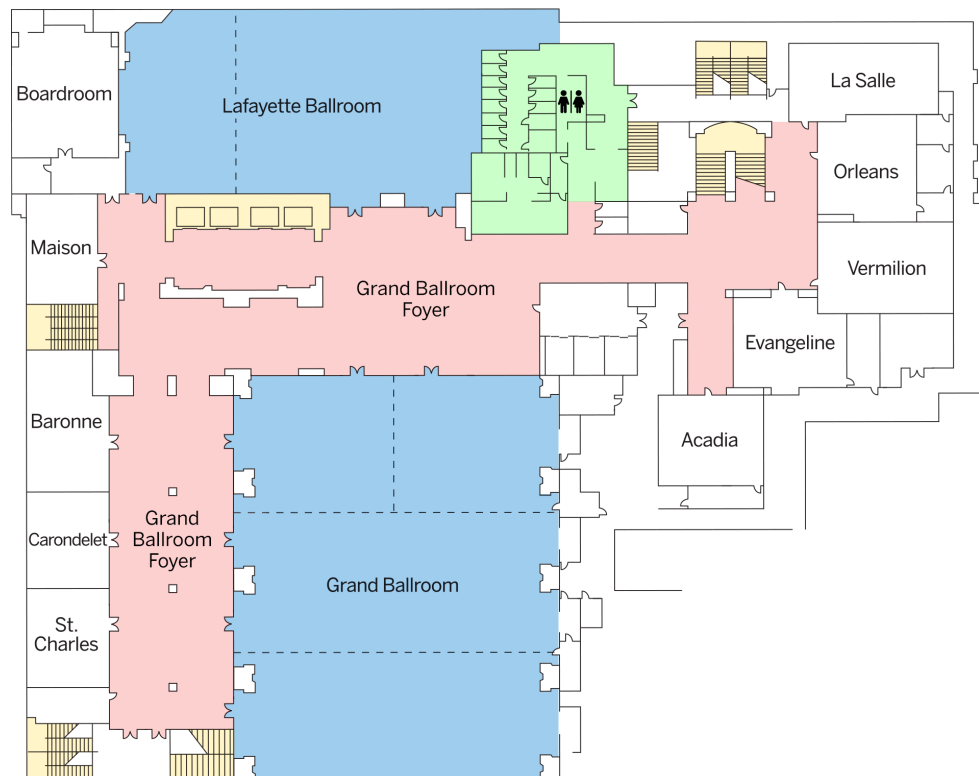

NOTE: This agenda may be updated or modified without notification.

SAVE THE DATE!

THE ELEVENTH ANNUAL  
**PA'S GUIDE TO THE  
MUSCULOSKELETAL  
GALAXY**

JUNE 25-29, 2019 | NASHVILLE, TN

REGISTRATION OPENS IN EARLY 2019







## Special Thanks

AAPA and AAOS would like to thank the following companies for sponsoring  
**The Tenth Annual PA's Guide to the Musculoskeletal Galaxy!**



Ferring Pharmaceuticals Inc. is a subsidiary of Ferring Pharmaceuticals, a privately owned, international pharmaceutical company. Ferring Pharmaceuticals specializes in the research, development and commercialization of compounds in orthopaedics, general and pediatric endocrinology, gastroenterology, infertility, obstetrics/gynecology, and urology.

For more information, call 1-888-FERRING (1-888-337-7464) or visit [www.FerringUSA.com](http://www.FerringUSA.com).



The Certified Hand Therapist (CHT) credential is recognized by many professional organizations as a benchmark for excellence in hand therapy. Medical professionals such as PAs and NPs can trust Certified Hand Therapists to efficiently and effectively manage their patient's hand rehabilitation needs. Visit our booth to find out more.

To locate a Certified Hand Therapist (CHT) near you, visit [www.htcc.org/find-a-cht](http://www.htcc.org/find-a-cht).

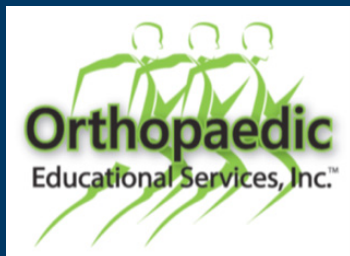

Orthopaedic Educational Services, Inc. provides physician assistants, nurse practitioners, primary/urgent care physicians and other healthcare professionals a forum to cultivate, refine and expand their orthopaedic knowledge and skills via our online learning modules.

For more information, visit [www.orthoedu.com](http://www.orthoedu.com).